

BOM see sheet 2/3

02	30/01/2026	Y. Magnard	J.-J. Correia	Add cut GG folio 2/3	M. Chebbo
01	05/12/2024	Y. Magnard	J.-J. Correia	FIRST EDITION	M. Chebbo
INDICE Issue	DATE	AUTEUR Author	VERIFIE PAR Checked by	MODIFICATIONS - observations	APPROUVE PAR approved by
MATERIE material				General tolerances : ISO 2768 mk	MASSE weight 61,4 KG
TRAITEMENT DE SURFACE surface treatment				Etats de surfaces (surface finish) Ra 3.2 sauf indication	QUANTITE (quantity)
				Filetages (Threads) : 6H	
CS 40700 F-38058 GRENOBLE CEDEX 9 adresse géographique : Bât OSUG A 414 rue le piscine domaine universitaire 38400 St MARTIN DHERES Tel : +33 4 76 51 47 88		FORMAT A1 SIZE ECHELLE 1:1 SCALE	TITRE-Title LGS WFS ROTATOR MOTION (RMA) ASSEMBLY		DWG N° E-MAO-PLA-09-02-04-00
Ce document ne peut être reproduit divulgué ou utilisé sans autorisation - This document may not be used, reproduced, transmitted without Authorization.					IND- Issue FOLIO- Sheet 02 / 1/3

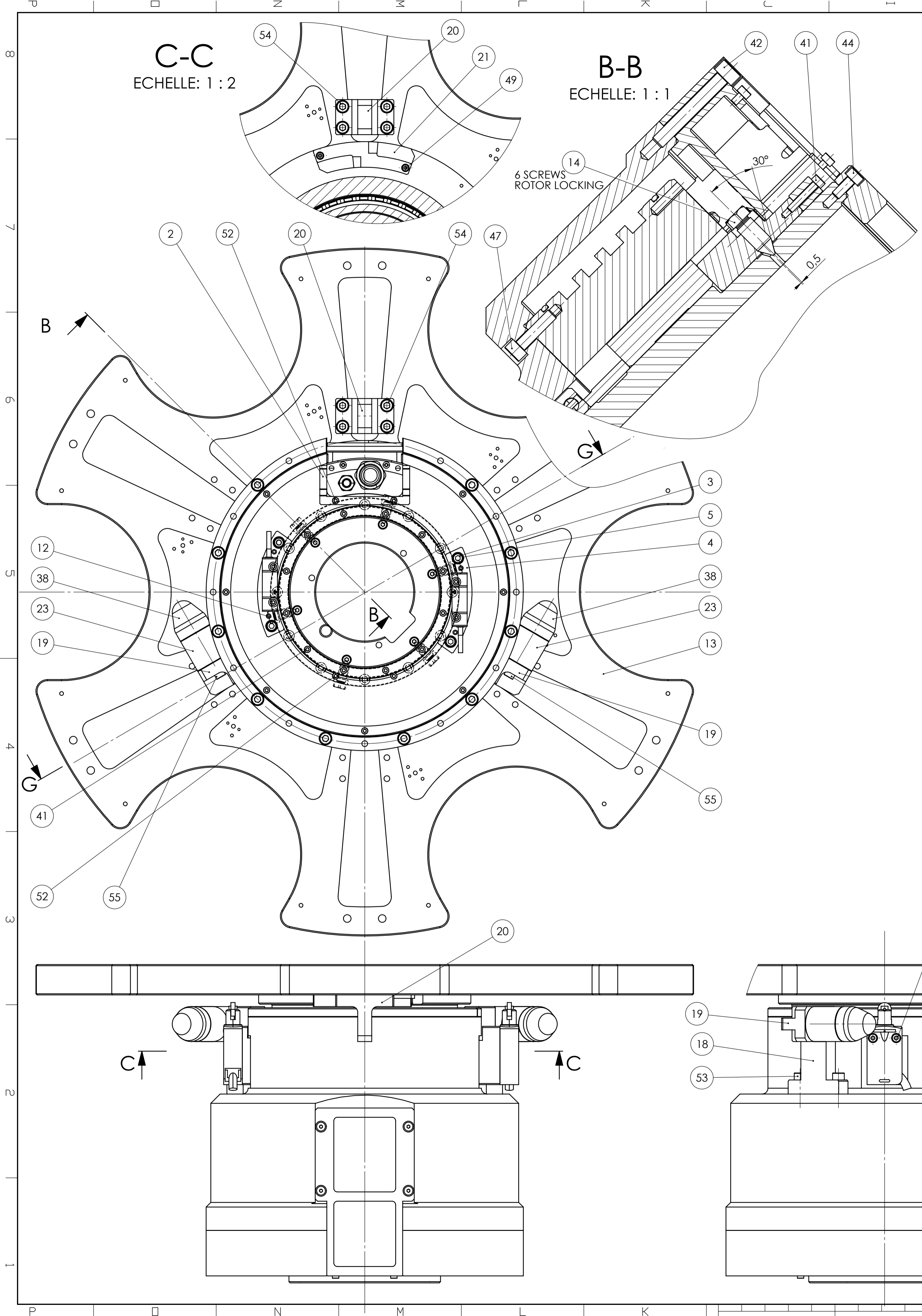

No	NUMERO DE PIECE	Description	Material	masse (g)	observations
1	E-MAO-PLA-09-02-04-01	BEARING FLANGE	X2CrNi19-11(304L)	2 300.65	
2	E-MAO-PLA-09-02-04-02	CACHE	EN AW-5083	1 65.43	
3	E-MAO-PLA-09-02-04-03	CAPTIVE SCREW	Inox	5 4.11	
4	E-MAO-PLA-09-02-04-04	CODEUR HEAD PLATE	S355 (E36)	2 58.18	
5	E-MAO-PLA-09-02-04-06	DOWEL	X2CrNi19-11(304L)	4 6.44	
6	E-MAO-PLA-09-02-04-08	HEAD COVER	EN AW-5083	1 47.21	
7	E-MAO-PLA-09-02-04-09	HEAD COVER SYM	EN AW-5083	1 47.21	
8	E-MAO-PLA-09-02-04-10	HOUSING	X2CrNi19-11(304L)	1 13913.73	
9	E-MAO-PLA-09-02-04-11	LOWER FLANGE	X2CrNi19-11(304L)	1 3841.73	
10	E-MAO-PLA-09-02-04-12	MOTOR FLANGE	X2CrNi19-11(304L)	1 2204.36	
11	E-MAO-PLA-09-02-04-13	MOTOR SPACER	X2CrNi19-11(304L)	1 421.23	
12	E-MAO-PLA-09-02-04-14	PIN	X2CrNi19-11(304L)	4 1.12	
13	E-MAO-PLA-09-02-04-15	PROBES PLATE	EN AW-5083	1 9182.74	
14	E-MAO-PLA-09-02-04-17	SCREW	AISI 420	6 9.27	
15	E-MAO-PLA-09-02-04-18	SHAFT	X2CrNi19-11(304L)	1 11464.27	
16	E-MAO-PLA-09-02-04-19	BEARING SPACER	X2CrNi19-11(304L)	1 990.09	
17	E-MAO-PLA-09-02-04-20	SWITCH PLATE	EN AW-5083	1 22.31	
18	E-MAO-PLA-09-02-04-21	HARD STOP SUPPORT	EN AW-7075	2 87.73	
19	E-MAO-PLA-09-02-04-22	HARD STOP BRACKET	EN AW-7075	2 51.81	
20	E-MAO-PLA-09-02-04-23	STOP PART	EN AW-7075	1 64.05	
21	E-MAO-PLA-09-02-04-24	DETECTION PLATE	X5CrNiMo17-12-2(316)	1 100.52	
22	E-MAO-PLA-09-02-04-25	SWITCH PLATE 2	EN AW-5083	1 59.48	
23	E-MAO-PLA-09-02-04-26	HARD STOP SPACER	EN AW-7075	2 54.56	
24	E-MAO-PLA-09-02-04-27	LOWER COVER	S235JR (1.0038)	1 475.73	
25	E-MAO-PLA-09-02-04-28	COVER	EN AW-7075	1 142.01	
26	E-MAO-PLA-09-02-04-29	ALIGN CAMERA INTERFACE	X2CrNi19-11(304L)	1 691.67	
27	E-MAO-PLD-11-00-00-01	BEARING MOUNTING TOOL	EN AW-7075	1 2472.87	
28	E-MAO-PLD-11-00-00-02	BEARING MOUNTING FLANGE	EN AW-7075	2 294.73	
29	E-MAO-PLD-11-00-00-03	BEARING MOUNTING ROD	Matériau <non spécifié>	1 61.04	
30	E-MAO-PLD-12-00-00-01	ROTOR CENTERING TOOL	EN AW-5083	1 544.7	
31	E-MAO-PLA-09-02-01-00	ENCODER RING TTR-ECA-4402-148-20	Inox	1 0.350	HEIDENHAIN
32	E-MAO-PLA-09-02-02-00	LIMIT SWITCH XCMD2102L1		2	
33	E-MAO-PLA-09-02-03-00	ETEL TMB+0210-050 STATOR	Inox	1 11370	ETEL
34	E-MAO-PLA-09-02-03-00-rotor	ETEL TMB+0210-050 ROTOR	Inox	1 11370	ETEL
35	E-MAO-PLA-09-02-05-00	AK ECA 4410	X	2 0.100	ENCODER HEAD HEIDENHAIN
36	E-MAO-PLA-09-02-04-07	KAYDON-X15013-XP4A	Inox	1 0.480	FOUR POINT CONTACT BALL BEARING
37	E-MAO-PLA-09-02-04-16	KAYDON-X14013-CP4A	100Cr6 (Stub)	1 0.450	RADIAL BALL BEARING
38	E-MAO-PLA-10-02-01-39	BUTEE PROGRESSIVE CONIQUE 512307	Matériau <non spécifié>	2 15.74	PAULSTRA
39	ISO 4762 M5 x 12 - 12N			12	A2-70
40	ISO 4762 M5 x 30 - 22N			12	A2-70
41	ISO 4762 M3 x 16 - 16N			12	A2-70
42	ISO 4762 M6 x 40 - 24N			10	A2-70
43	ISO 10642 - M3 x 8 - 8N			4	A2-70
44	ISO 4762 M4 x 10 - 10N			10	A2-70
45	ISO 4762 M4 x 20 - 20N			2	A2-70
46	ISO 4762 M3 x 5 - 5N			7	A2-70
47	ISO 4762 M5 x 20 - 20N			20	A2-70
48	ISO 4762 M8 x 25 - 25N			6	A2-70
49	ISO 4762 M3 x 10 - 10N			2	A2-70
50	ISO 10669-3-N			4	A2-70
51	ISO 4762 M3 x 25 - 18N			4	A2-70
52	ISO 4762 M3 x 6 - 6N			4	A2-70
53	ISO 4762 M6 x 20 - 20N			4	A2-70
54	ISO 4762 M6 x 12 - 12N			4	A2-70
55	ISO 4762 M5 x 16 - 16N			4	A2-70
56	ISO 10642 - M4 x 12 - 12N			4	A2-70
57	ISO - 4032 - M12 - D - N			2	
58	ISO 4762 M4 x 16 - 16N			2	

02	30/01/2026	Y. Magnard	J.-J. Correia	See sheet 1	M. Chebbo
01	05/12/2025	Y. Magnard	J.-J. Correia	FIRST EDITION	M. Chebbo
INDICE	DATE	AUTEUR	VERIFIE PAR	MODIFICATIONS - observations	APPROUVE PAR
Issue		Author	Checked by		approved by
MATERIE material				General tolerances : ISO 2768 mk	MASSE weight
TRAITEMENT DE SURFACE surface treatment				Etats de surfaces (surface finish)	KG
				Ra 3.2 sauf indication	QUANTITE (quantity)
				Filetages (Threads) : 6H	
CS 40700 F-38058 GRENOBLE CEDEX 9 adresse géographique : Bât OSUG A 414 rue le piscine domaine universitaire 38400 St MARTIN DHERES Tel : +33 4 76 51 47 88		FORMAT A1 SIZE 1:2 ECHELLE SCALE	TITRE-Title LG S WFS ROTATOR MOTION (RMA) ASSEMBLY & BOM		DWG N° E-MAO-PLA-09-02-04-00 IND.-Issue/FOLIO-Sheet 02 / 2/3

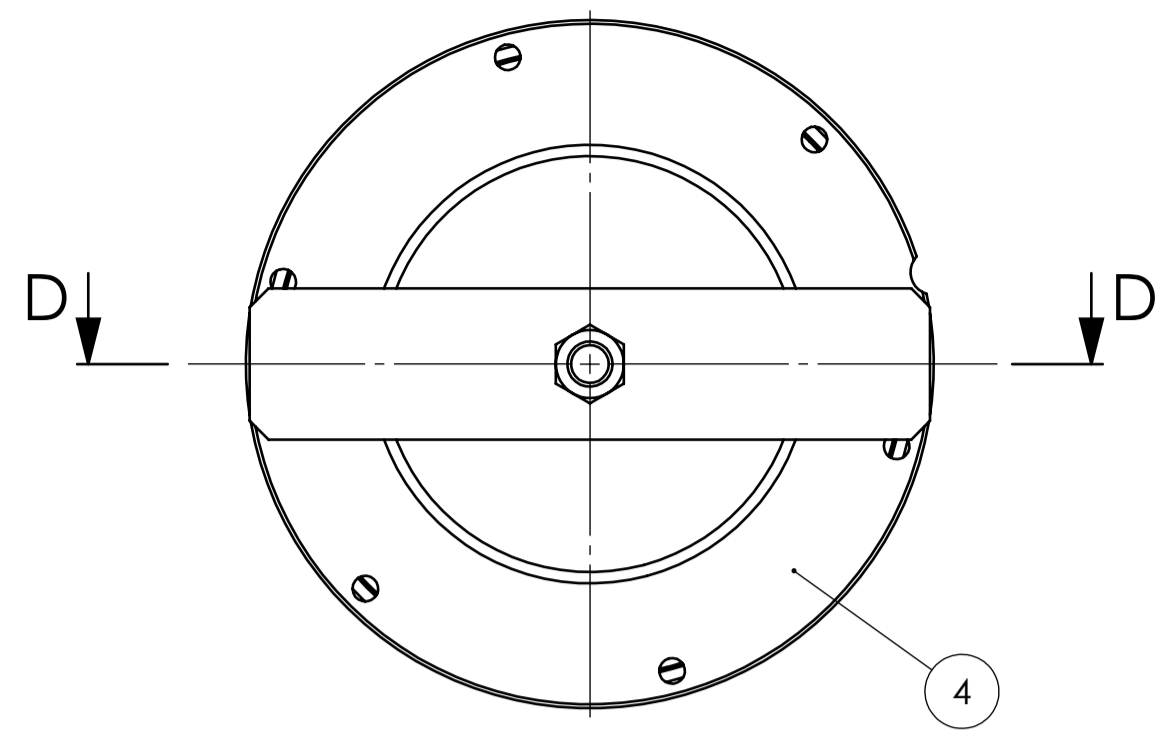

D-D
ECHELLE: 1 : 2
BEARING 1 MOUNTING

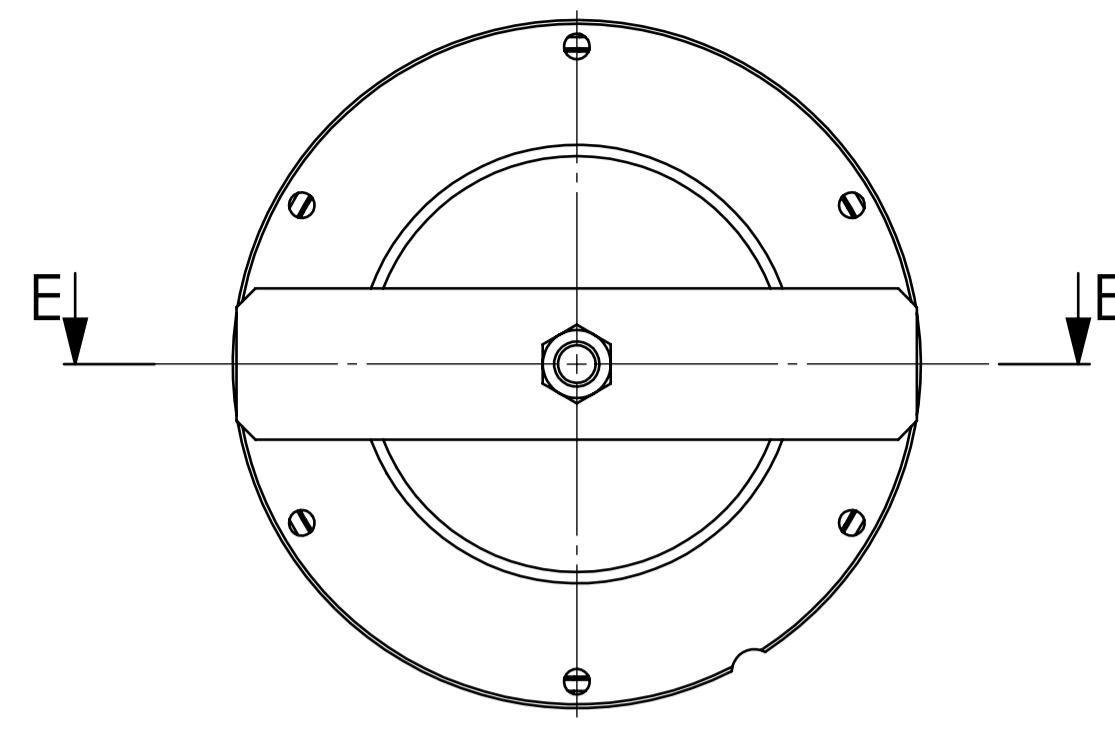

E-E
ECHELLE: 1 : 2
BEARING 2 MOUNTING

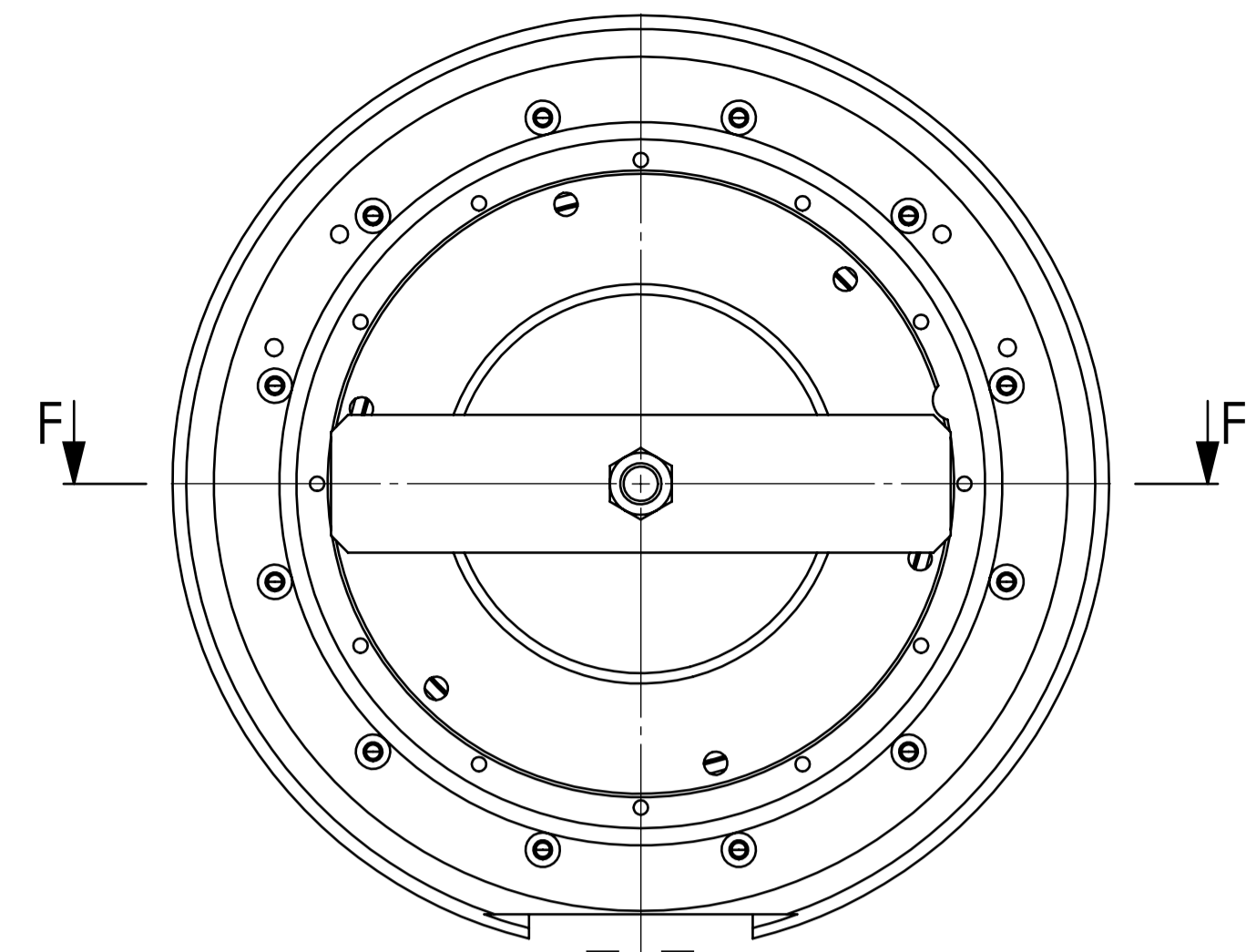

F-F
ECHELLE: 1 : 2
MOTOR ROTOR MOUNTING

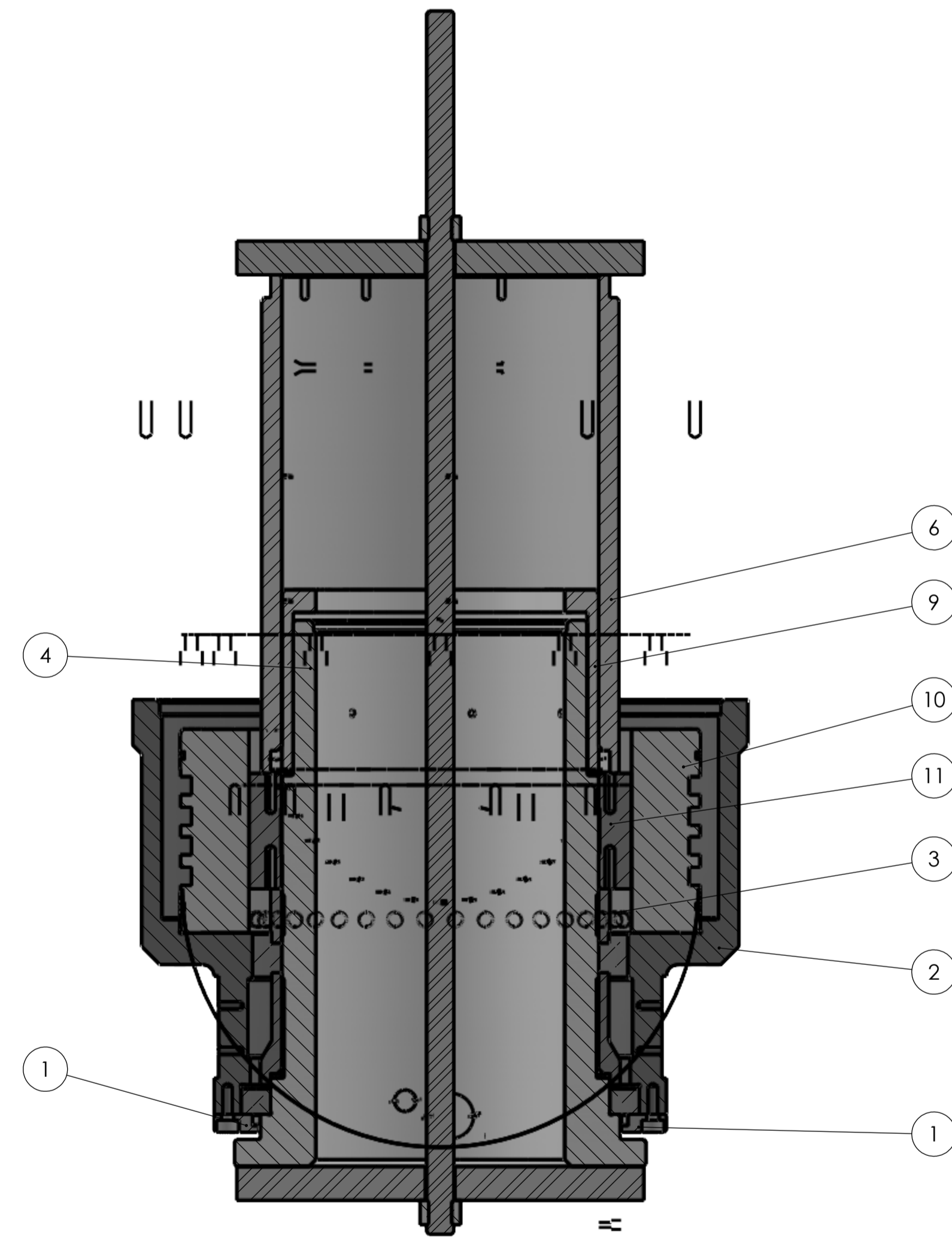
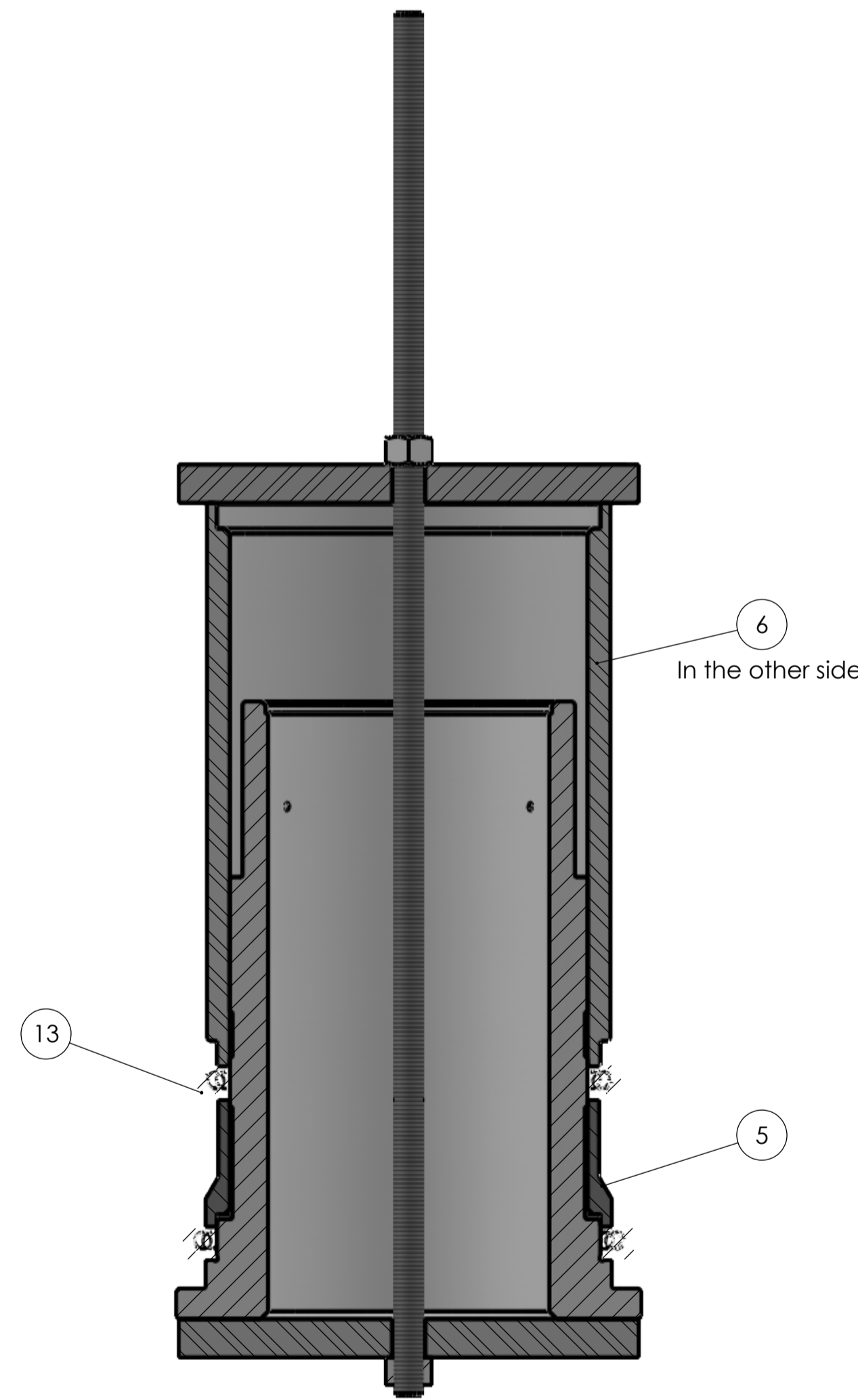
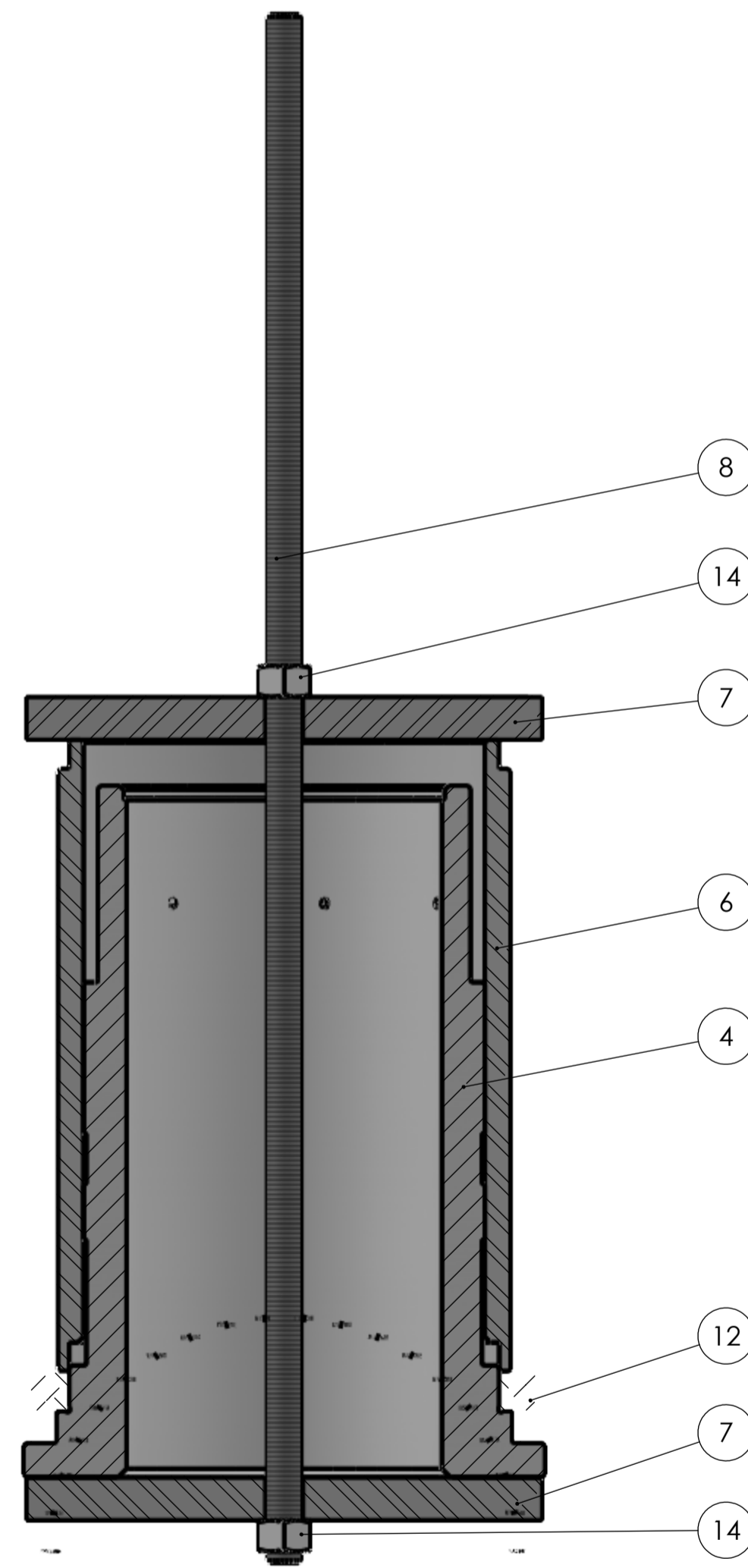

No	NUMERO DE PIECE	Description	Material		masse (g)	observations
1	E-MAO-PLA-09-02-04-01	BEARING FLANGE	X2CrNi19-11(304L)	2	300.65	
2	E-MAO-PLA-09-02-04-10	HOUSING	X2CrNi19-11(304L)	1	13913.73	
3	E-MAO-PLA-09-02-04-13	MOTOR SPACER	X2CrNi19-11(304L)	1	421.23	
4	E-MAO-PLA-09-02-04-18	SHAFT	X2CrNi19-11(304L)	1	11464.27	
5	E-MAO-PLA-09-02-04-19	BEARING SPACER	X2CrNi19-11(304L)	1	990.09	
6	E-MAO-PLD-11-00-00-01	BEARING MOUNTING TOOL	EN AW-7075	1	2472.87	
7	E-MAO-PLD-11-00-00-02	BEARING MOUNTING FLANGE	EN AW-7075	2	294.73	
8	E-MAO-PLD-11-00-00-03	BEARING MOUNTING ROD	Matériau <non spécifié>	1	61.04	
9	E-MAO-PLD-12-00-00-01	ROTOR CENTERING TOOL	EN AW-5083	1	544.7	
10	E-MAO-PLA-09-02-03-00	ETEL TMB+0210-050 STATOR	Inox	1	11370	ETEL
11	E-MAO-PLA-09-02-03-00-rotor	ETEL TMB+0210-050 ROTOR	Inox	1	11370	ETEL
12	E-MAO-PLA-09-02-04-07	KAYDON-X15013-XP4A	Inox	1	0.480	FOUR POINT CONTACT BALL BEARING
13	E-MAO-PLA-09-02-04-16	KAYDON-X14013-CP4A	100Cr6 (Stub)	1	0.450	RADIAL BALL BEARING
14	ISO - 4032 - M12 - D - N			2		
15	ISO 4762 M5 x 12 - 12N			11		

02	30/01/2026	Y.Magnard	J.-J.Correia	see sheet 1	M.Chebbo
01	05/12/2025	Y.Magnard	J.-J.Correia	FIRST EDITION	M.Chebbo
INDICE	DATE	AUTEUR	VERIFIE PAR	MODIFICATIONS - observations	APPROUVE PAR
Issue		Author	Checked by		approved by
MATERIE material				General tolerances : ISO 2768 mk	
TRAITEMENT DE SURFACE surface treatment				Etats de surfaces (surface finish)	
				Ra 3.2 sauf indication	
				Filetages (Threads) : 6H	
Institut de Recherche et d'Innovation 414 rue le piscine domaine universitaire 38400 St MARTIN DHERES Tel : +33 4 76 51 47 88				CS 40700 F-38058 GRENOBLE CEDEX 9 adresse géographique : Bât OSUG A 414 rue le piscine domaine universitaire 38400 St MARTIN DHERES Tel : +33 4 76 51 47 88	
LGS WFS ROTATOR MOTION (RMA) MOUNTING TOOLS				DWG N° E-MAO-PLA-09-02-04-00 02 3/3	